



CONTACT US:
H.O. BOSTROM CO., INC.
818 PROGRESS AVE., WAUKESHA, WI 53186
SALES@HOBOSTROM.COM
T 262.542.0222 | 800.332.5415 | F 262.542.9247

INSTALLATION INSTRUCTIONS FOR ZIP CLEAN BOLSTER COVERS

GENERAL PRODUCT INFORMATION

Studies show that a wet-soap decon can reduce cancer causing contamination on gear by up to 85%.* Zip Clean seats are designed with covers that can be zipped off, machine washed and hung to dry. Covers are made with Durawear Plus™ material which has a waterproof backing, dries quickly, and is puncture and tear resistant. In addition, Zip Clean seats utilize a Foam Block™ encapsulated barrier which reduces the absorption of gases into the seat. Encapsulated foam can be wiped clean, further supporting the cleanability of the product.

DOCUMENT PURPOSE

The purpose of this document is to illustrate how to remove and replace Zip Clean bolster covers. It is important that the installer read and understand all safety information and instructions before starting the installation procedure.

SAFETY INFORMATION

⚠ DANGER indicates a hazardous situation which, if not avoided, **WILL** result in death or serious injury.

⚠ WARNING indicates a hazardous situation which, if not avoided, **COULD** result in a death or serious injury.

⚠ CAUTION indicates a hazardous situation which, if not avoided, **COULD** result in minor or moderate injury.

NOTICE is used to address practices not related to physical injury.

SAFETY INSTRUCTIONS (or equivalent) signs indicate specific safety related instructions or procedures.

PARTS LIST

8083-12XXX: KIT BOLST CVR (6513U) ABTS ZIP CLN

Item No.	Description	Qty
1	CVR UPPER BOLST ABTS ZIP	2

TOOLS REQUIRED

None

DEFINITION OF TERMS

1. Hook and Loop.



Figure 1

SCBA BOLSTER COVER REMOVAL

1. Unzip bolster covers on both sides of frame. See Figure 2.



Figure 2

2. Separate zippers on both sides at top of bolster. Separate hook and loop on top surface of bolster. See Figure 3. Remove cover.

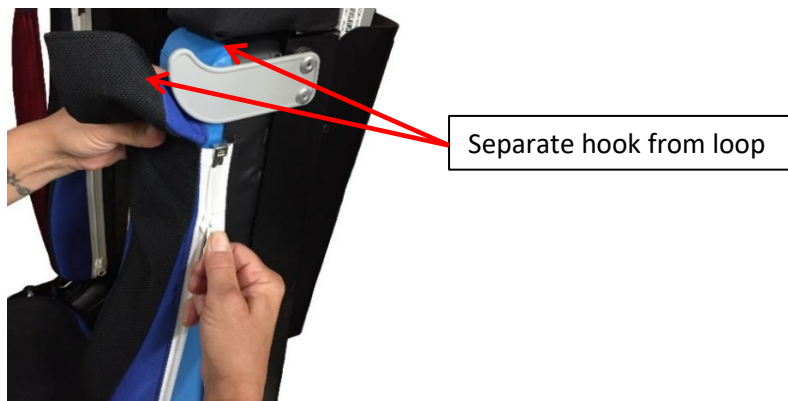

Figure 3

SCBA BOLSTER COVER INSTALLATION

NOTICE: The installer is liable for cover installation. Failure to properly install cover may result in the cover shifting and/or coming loose.

1. Attach zippers on both sides of bolster. See Figure 4.



Figure 4

REPLACEMENT INSTRUCTIONS
ZIP CLEAN BOLSTER COVERS

H.O. BOSTROM CO., INC.
SALES@HOBOSTROM.COM
T 262.542.0222 | 800.332.5415

2. Close zipper halfway down bolster. See Figure 5.



Figure 5

3. Align seams on front edge of cover to edges of foam. See Figure 6.



Figure 6

4. Fully close zippers. See Figure 7.



Figure 7

REPLACEMENT INSTRUCTIONS
ZIP CLEAN BOLSTER COVERS

H.O. BOSTROM CO., INC.
SALES@HOBOSTROM.COM
T 262.542.0222 | 800.332.5415

5. Fasten hook and loop on top surface of bolster. See Figure 8.

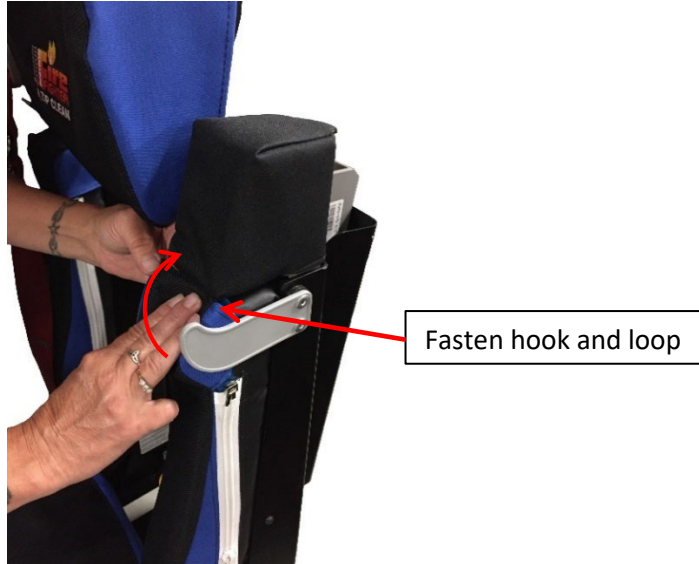

Figure 8

IMPROPER INSTALLATION:

If the cover looks wrinkly and crooked, fully unzip covers and repeat steps 1 through 5.



Figure 9

*Journal of Occupational and Environmental Hygiene. DOE: 10.1080/15459624.2017.1334904